

## **Traffic Management**

Ann Cunningham: Head of Traffic Management



# **Traffic Management Information: Wightman Road Bridge and associated works**

Dear Resident or Business,

I write to inform you of the traffic management arrangements that are being put in place for the duration of the Wightman Road Bridge strengthening works. I am also providing a brief overview of other works underway in your area.

This includes;

- Green Lanes Traffic Study
- Electrification of the Gospel Oak to Barking Train Line,
- Improvement to Finsbury Park Station

### **Wightman Road Rail Bridge Replacement**

As you may be aware, the Council secured funding from Transport for London (TfL) for the strengthening of the Wightman Road Bridge. Work includes replacement of the bridge deck and raising its height to accommodate the electrification of the Gospel Oak to Barking train line. Carrying out these works simultaneously will minimise disruption to the transport network.

The actual construction of the new bridge is being undertaken by Network Rail and their contractors. Although the works have begun, the road will not be closed until 29 March 2016 so as to avoid school term and to coincide with school holidays; when roads are quieter and to ensure that there is no conflict with the current closure of Stroud Green Road for railway station works. The closure will be in place for 5 months.

The Council has been supporting Network Rail with community engagement since December 2015 and raising awareness of these works, which will of course cause some disruption for local residents and businesses. A series of public meetings, presentations and drop-in sessions have been held. In addition both the Council and Network Rail have distributed letters to residents and businesses.

Detailed preparations have been underway for several months to minimise the impact and ensure continuity of operation for businesses and schools. Every effort has been made to anticipate problems, with contingency plans in place to deal with any additional issues arising during this period that may impact on the road network.

**Traffic Management**  
**Level 5 Alexandra House**  
10 Station Road, Wood Green  
London N22 7TR

020 8489 1000

[www.haringey.gov.uk](http://www.haringey.gov.uk)

We anticipate that the closure will increase the numbers of vehicles attempting to use the ladder roads to either gain access to Green Lanes or avoid traffic congestion on it. It is therefore important that the physical closures are placed strategically to minimise the increase of traffic on the ladder roads, whilst maintaining access for residents, businesses and emergency services.

It has been agreed to close Wightman Road at the junction with Turnpike Lane and intersperse further closures along Wightman Road to inhibit its use as a route to avoid traffic on Green Lanes. We will use signage and traffic marshals to allow access to businesses and properties as far south as Hampden Road only. This will ensure business premises and Hornsey rail depot have access. All other access to Wightman Road will be by way of the ladder roads and we believe that this achieves the right balance. Please see the attached plan for details.

Further information regarding traffic management arrangements and about the project is available on Haringey's website

<http://www.haringey.gov.uk/parking-roads-and-travel/roads-and-streets/road-safety/road-safety-consultations/bridge-reconstruction-work-wightman-road>

### **Green Lanes Area Transport Study**

In response to concerns raised by residents, the Council agreed to undertake a review of traffic arrangements in the Green Lanes area. This study has now commenced, following the appointment of a consultancy: Steer Davies Gleave (SDG) in February 2016.

SDG are tasked with developing a series of proposals to identify and achieve a number of outcomes including a better and more equitable distribution of traffic, recognising the specific issues and problems within the area.

The aim of the study is to identify measures to:

- improve road safety for all road users;
- enhance pedestrian and cycle accessibility into and within the study area.
- maintain or enhance bus service journey times and reliability;
- rationalise traffic volume and routes and
- improve quality of life for residents.

Nothing is being ruled out in terms of the options to be examined, and these options will be informed by stakeholder input and other evidence gathered. It is important that any options taken forward are supported by the wider community. The first stages will involve the Consultant engaging with the Council, local Councillors and key stakeholders, businesses, residents and local community groups.

SDG have commenced the collection of evidence, and anticipate further engagement at the following points in addition to the ongoing dialogue that we anticipate and welcome;

- engagement (Spring 2016 ): an opportunity to share your views on the key issues affecting the area, and what you think a successful option should achieve;
- engagement (Autumn 2016): your chance to have a say on potential options.

Information on progress will be made available on the Council's website and will be updated regularly at <http://www.haringey.gov.uk/green-lanes-area-transport-study>

### **Electrification of Gospel Oak to Barking train Line**

The Electrification project will allow the replacement of the existing two carriage diesel trains with four carriage electric trains, greatly increasing capacity on the line which currently suffers from severe overcrowding on some services in the peak periods.

There will be no service between South Tottenham and Barking on weekdays and no service between Gospel Oak and Barking on weekends between June and September 2016. There will be a full closure of the line from September 2016 to February 2017. TfL will run rail replacement bus services during the period of the closure. Further information is available at:

<http://www.networkrail.co.uk/gobe/?cd=1>

### **Wells Terrace and other Finsbury Park Related Works**

Finsbury Park Underground station is being transformed over the next few years. When the upgrade is complete Finsbury Park Tube station will be more accessible (step-free), with passengers having more space. Journeys through the station will be quicker and more pleasant. A new, larger, and more accessible western station entrance will open by 2018, and lifts will be installed by mid 2018 providing step free access to all tube platforms,

### **Cross Boundary CPZ Issues (Islington)**

The London Borough of Islington viewed a number of CPZs bordering Haringey between July and September 2015. Haringey officers are working closely with them on changes arising to ensure that any impact on our roads is managed. We will work with our residents to ensure that their interests are safeguarded and relayed to Islington Council.

Yours faithfully,

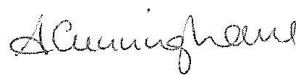

Ann Cunningham  
**Head of Traffic Management**

# Wightman road closure

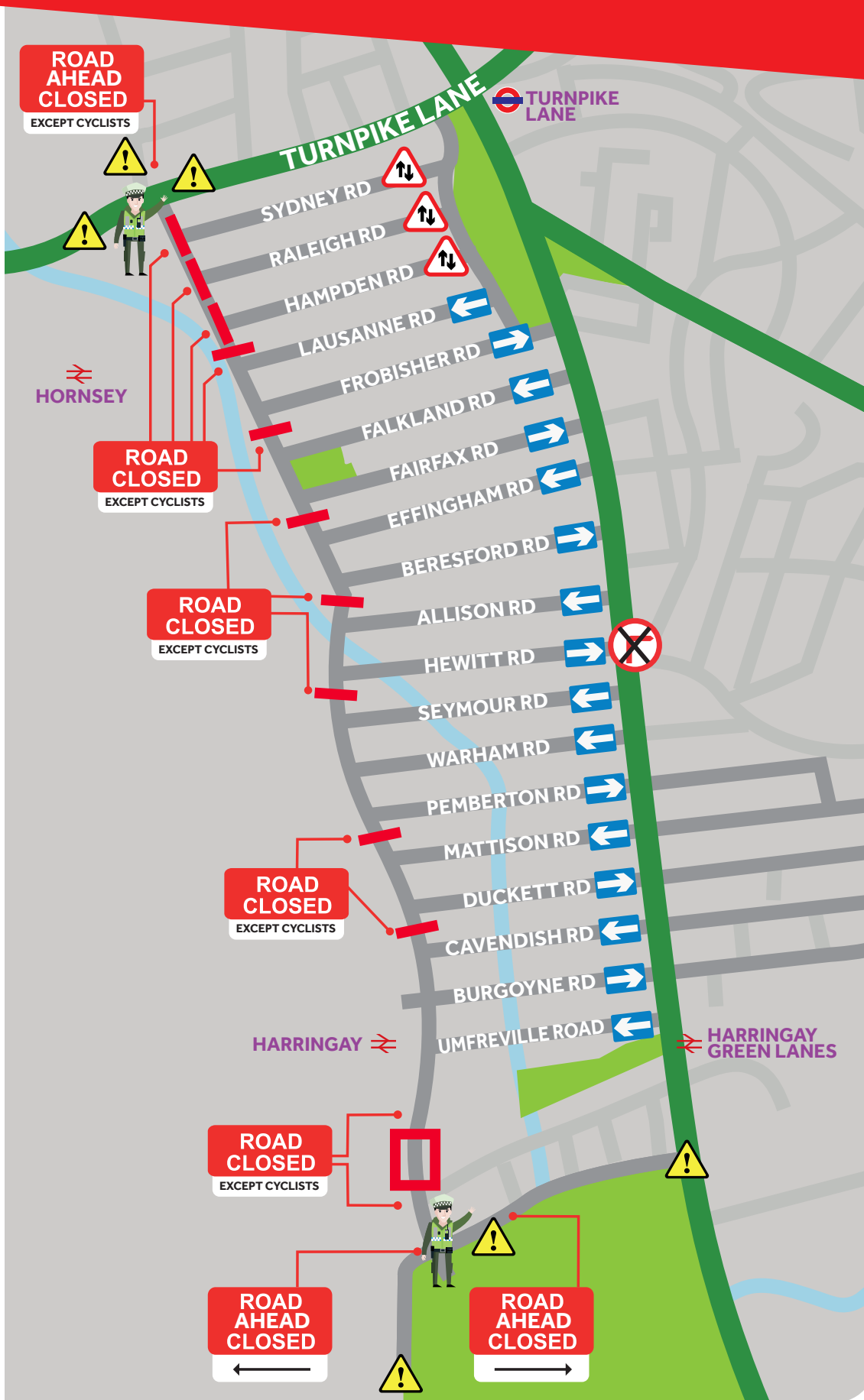

These roads will be made temporarily two way



Road closure points, they will be cycle accessible



The right turn bans at Hewitt Road and Salisbury Road will be rescinded



Traffic Marshall Locations



Enclosed works Area



**ADVANCE WARNING**  
**WIGHTMAN ROAD/ALROY ROAD**  
**CLOSED AT RAIL BRIDGE**  
**FROM 29<sup>TH</sup> MARCH TO SEPTEMBER 2016**  
**24hrs**  
 BRIDGE REPLACEMENT  
 FOR ENQUIRIES CONTACT NETWORK RAIL

Advance Warning  
 Signs Locations